

2" Square Operating Nut

IPEX offers a 2" square operating nut for our VKD and TKD true union ball valves. The nut is constructed of durable and corrosion resistant PVC that snaps directly on the valve stem without the need for a mounting kit. The nut allows for remote operation of a valve in a sump or trench using an extended T-wrench or key.



Applications:

- Below Grade Installations
 - Sump
 - Trench

1/2" to 2"

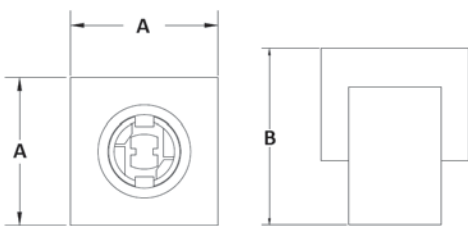

2-1/2" to 4"

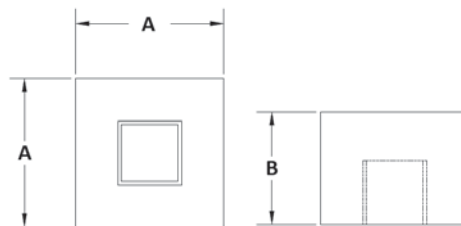

Part #	Description	A	B
253075	1/2" VKD/TKD TUBV 2" Square Operating Nut	2.00"	3.00"
253076	3/4" VKD/TKD TUBV 2" Square Operating Nut	2.00"	3.00"
253077	1" VKD/TKD TUBV 2" Square Operating Nut	2.00"	3.00"
253078	1-1/4" VKD/TKD TUBV 2" Square Operating Nut	2.00"	3.00"
253079	1-1/2" VKD/TKD TUBV 2" Square Operating Nut	2.00"	3.00"
253080	2" VKD/TKD TUBV 2" Square Operating Nut	2.00"	3.00"
253150	2-1/2" VKD TUBV 2" Square Operating Nut	2.00"	1.51"
253151	3" VKD TUBV 2" Square Operating Nut	2.00"	1.51"
253152	4" VKD TUBV 2" Square Operating Nut	2.00"	1.51"

Contact us

Visit our website: ipexna.com

Toll Free U.S.: (800) 463-9572